

nonlocked - keylocked - rotating mounting set
ungesichert - schlußschließung - drehbares Montageset
non seguridad - con llage - set de montaje giratorio
non sécurisé - à clé - set de fixation rotatives
onbeveiligd - sleutelsysteem - montageset draaibaar



User manual

Produkthandbuch
Manual del producto
Manuel du produit
Product handleiding



PACKAGING CONTENT	VERPACKUNGSGEHALT	CONTENIDO DEL EMBALAJE	CONTENU DE COLIS	VERPAKKINGSINHOUD
-------------------	-------------------	------------------------	------------------	-------------------



50661 (15NL)
50662 (18NL)



50671 (15KEY)
50672 (18KEY)

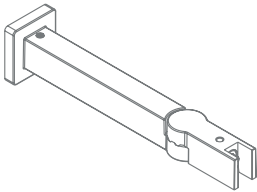

50698
(2x)

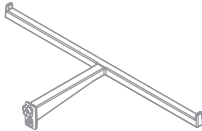

16003
(15/18x)

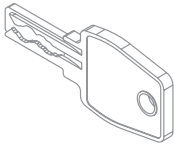

50660
(1x)

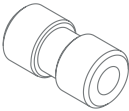

16084
Ø8,4x16
(2x)



16182
Ø7,2x16
(2x)

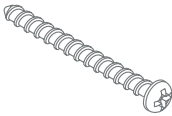

95132
3.5x50
(2x)

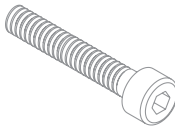

95052
M4x45
(2x)

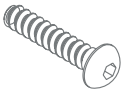

16086
M4x20
(2x)



16905
M4x4
(4x)



16186
M4x20
(2x)



95150
M4
(2x)



95624
M4
(2x)

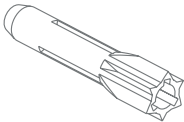

95092
S6x39
(2x)

REQUIRED TOOLS	BENÖTIGTEN WERKZEUGE	HERRAMIENTAS NECESARIAS	OUTILS NÉCESSAIRES	BENODIGDE GEREEDSCHAPPEN
----------------	----------------------	-------------------------	--------------------	--------------------------

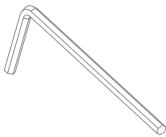

92041 #2
94060 #2.5
94034 #3

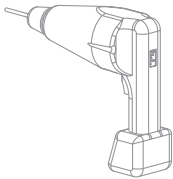

6mm (stone)
4,5mm (plexi)
2mm (wood)

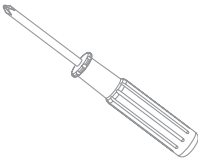

P2

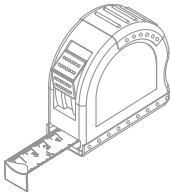

1

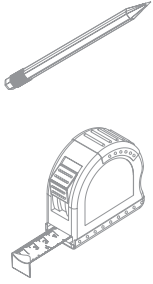

- A**
- 7 positions: 554 mm
 - 8 positions: 631 mm
 - 9 positions: 708 mm
 - 10 positions: 785 mm
 - 11 positions: 862 mm
 - 12 positions: 939 mm
 - 13 positions: 1016 mm
 - 14 positions: 1093 mm
 - 15 positions: 1170 mm
 - 16 positions: 1247 mm
 - 17 positions: 1324 mm
 - 18 positions: 1380 mm

B* 190mm

C* 1900mm

D** 16 positions: 650 mm
17 positions: 727 mm
18 positions: 706 mm

- * - Advised distance
- Vorgeschaener Abstand
 - Distancia aconsejable
 - Distance recommandée
 - Geadviseerde afstand

- ** - 3rd wall bracket
- Dritte Wandhalterung
 - Soporte de pared tercera
 - 3 support mural
 - 3e muurbeugel

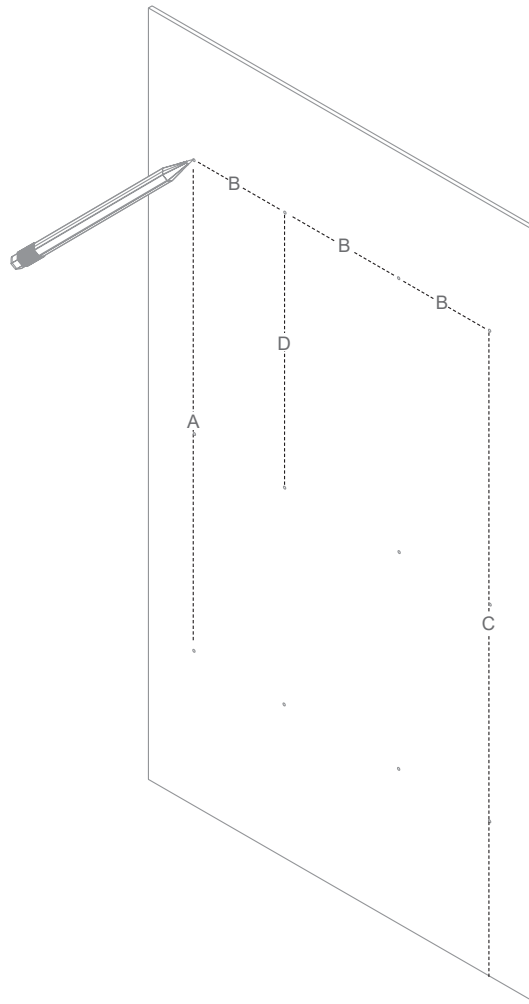

2

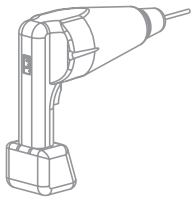

- A** Ø2 mm
- for assembly on a wooden panel
 - für die Montage auf einer Holzplatte
 - para el montaje en un panel de madera
 - pour le montage sur un panneau en bois
 - voor assemblage op een houten paneel
- Ø4,5 mm
- for assembly on a Plexi panel
 - für die Montage auf einer Plexiglasplatte
 - para el montaje en un panel de plexiglás
 - pour le montage sur un panneau en plexi
 - voor assemblage op een plexi paneel
- Ø6 mm
- for assembly on a stone wall
 - für die Montage auf einer Steinmauer
 - para el montaje en un muro de piedra
 - pour le montage sur un mur de pierre
 - voor assemblage op een stenen muur

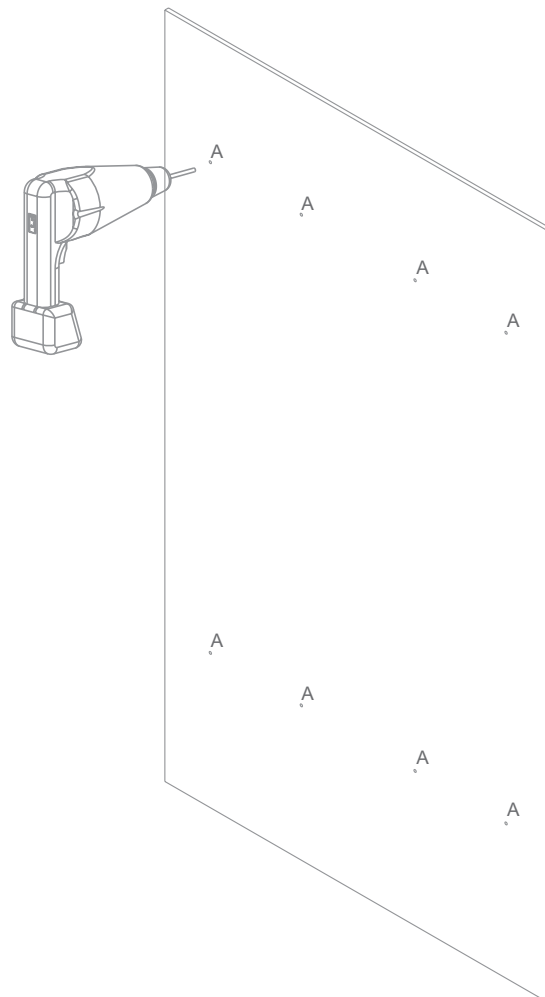

3 A

- for assembly on a wooden panel
- für die Montage auf einer Holzplatte
- para el montaje en un panel de madera
- pour le montage sur un panneau en bois
- voor assemblage op een houten paneel

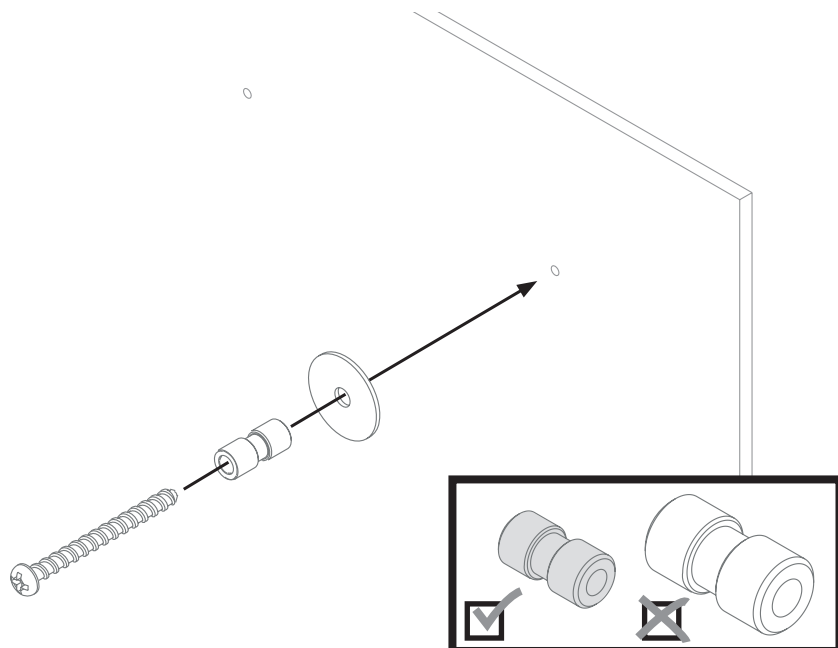
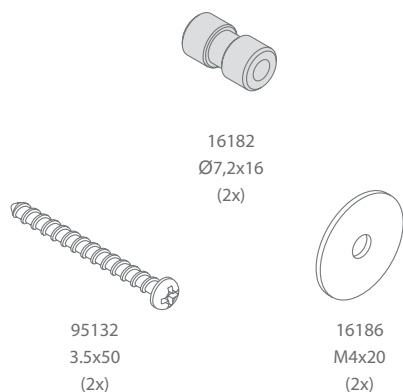

3 B

- for assembly on a stone wall
- für die Montage auf einer Steinmauer
- para el montaje en un muro de piedra
- pour le montage sur un mur de pierre
- voor assemblage op een stenen muur

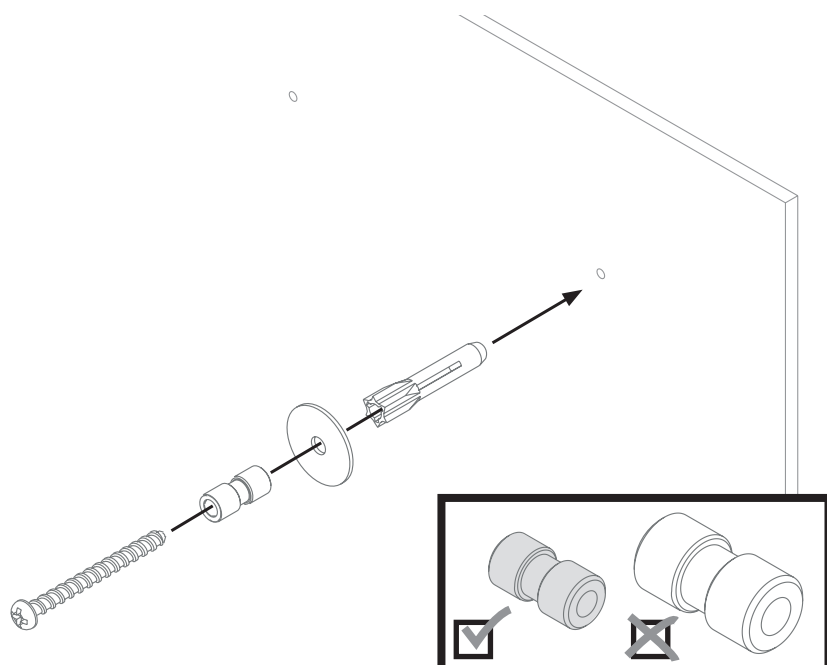
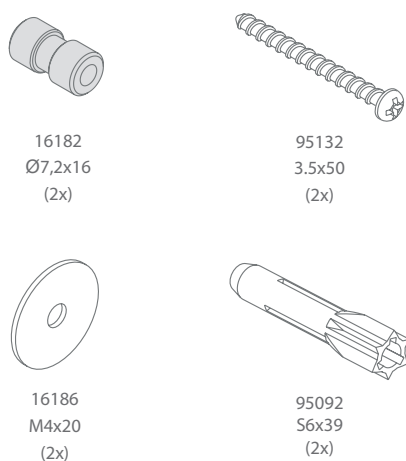

3 C

- for assembly on a Plexi panel
- für die Montage auf einer Plexiglasplatte
- para el montaje en un panel de plexiglás
- pour le montage sur un panneau en plexi
- voor assemblage op een plexi paneel

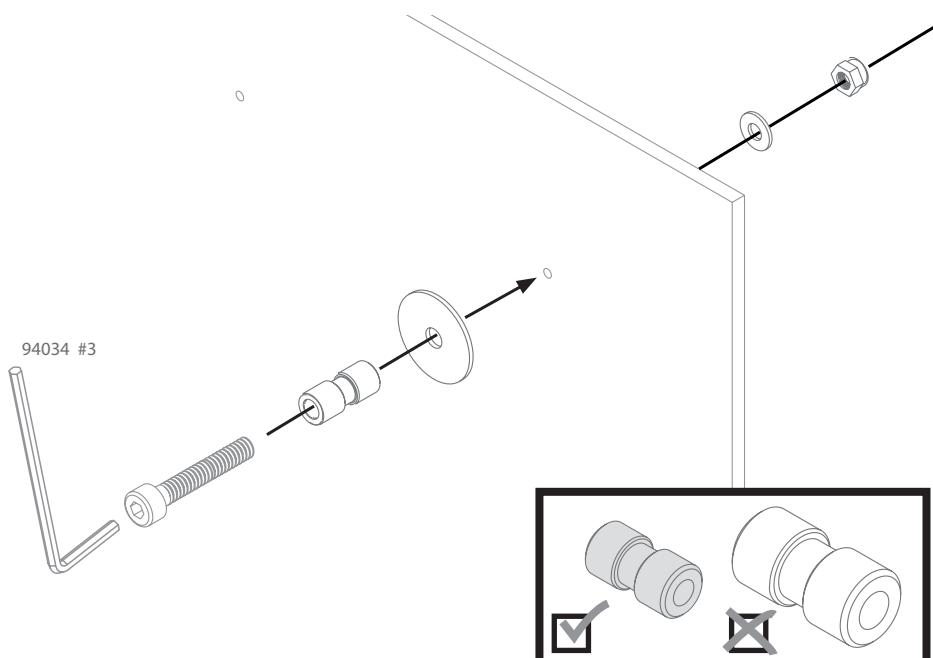
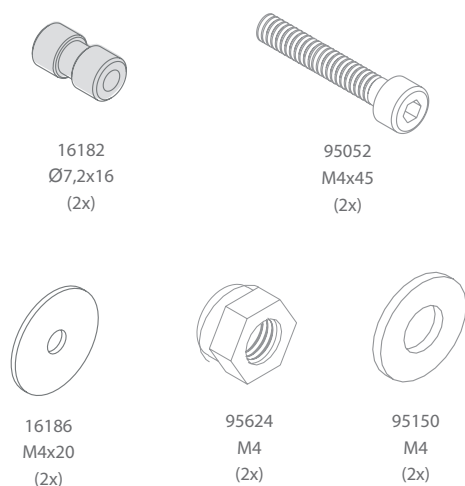

4

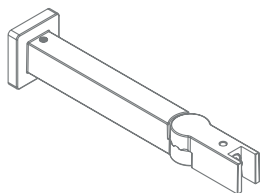

50698
(2x)

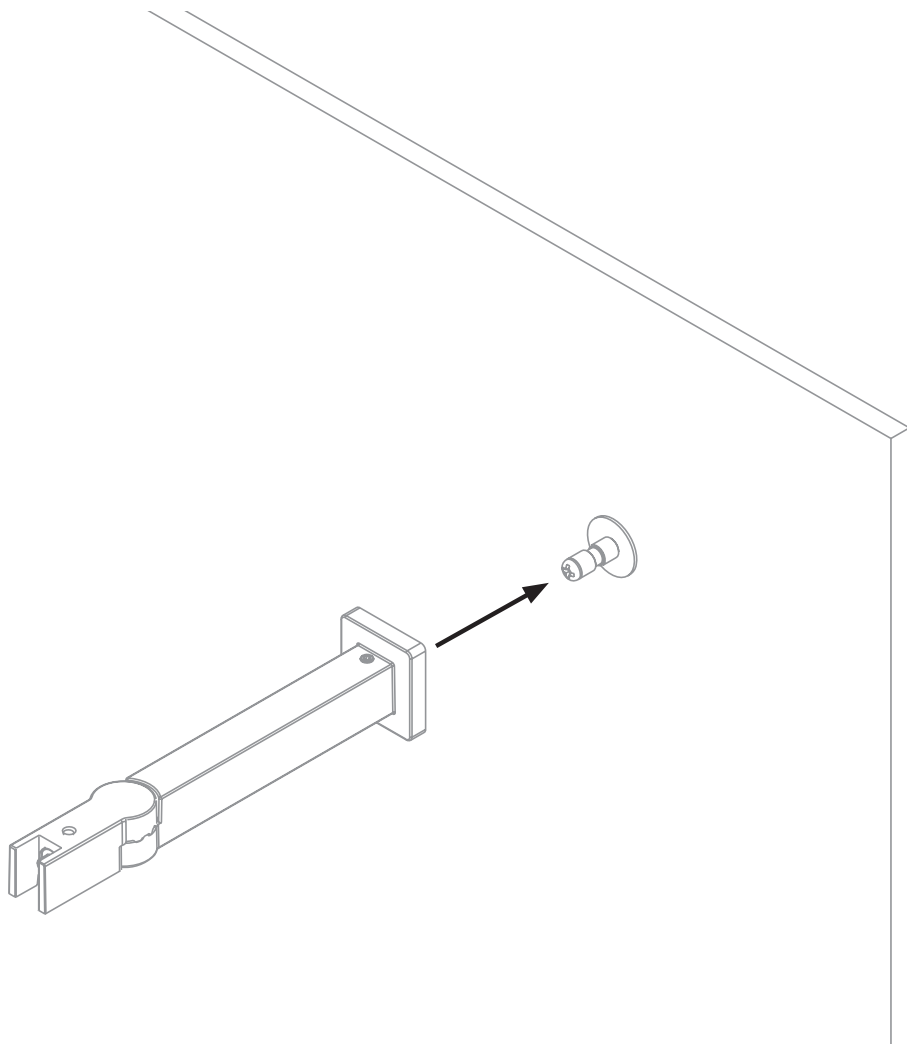

5



16905 (2x)
M4x4



92041 (1x)
#2

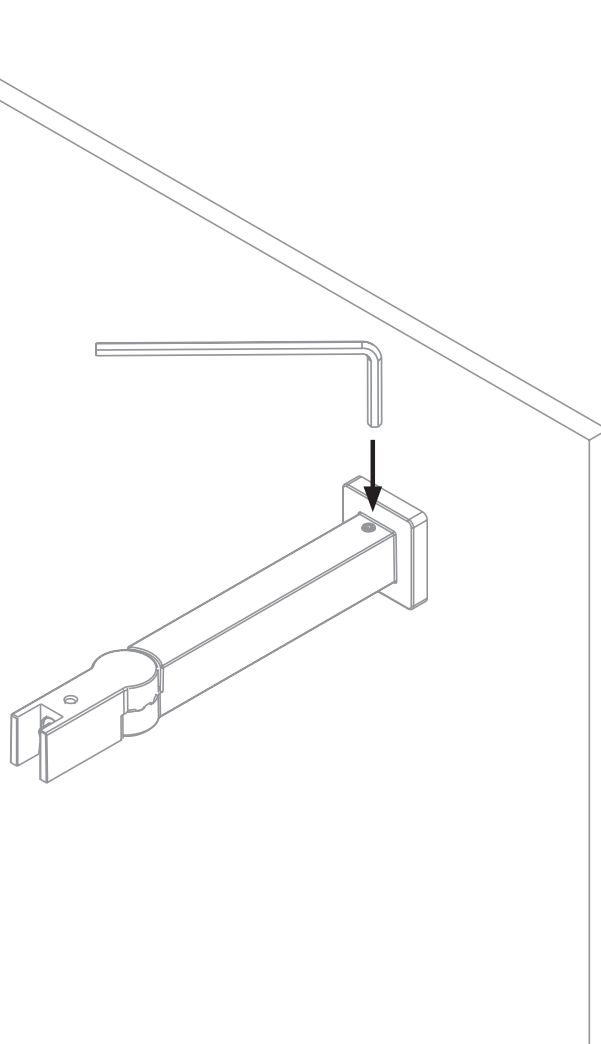

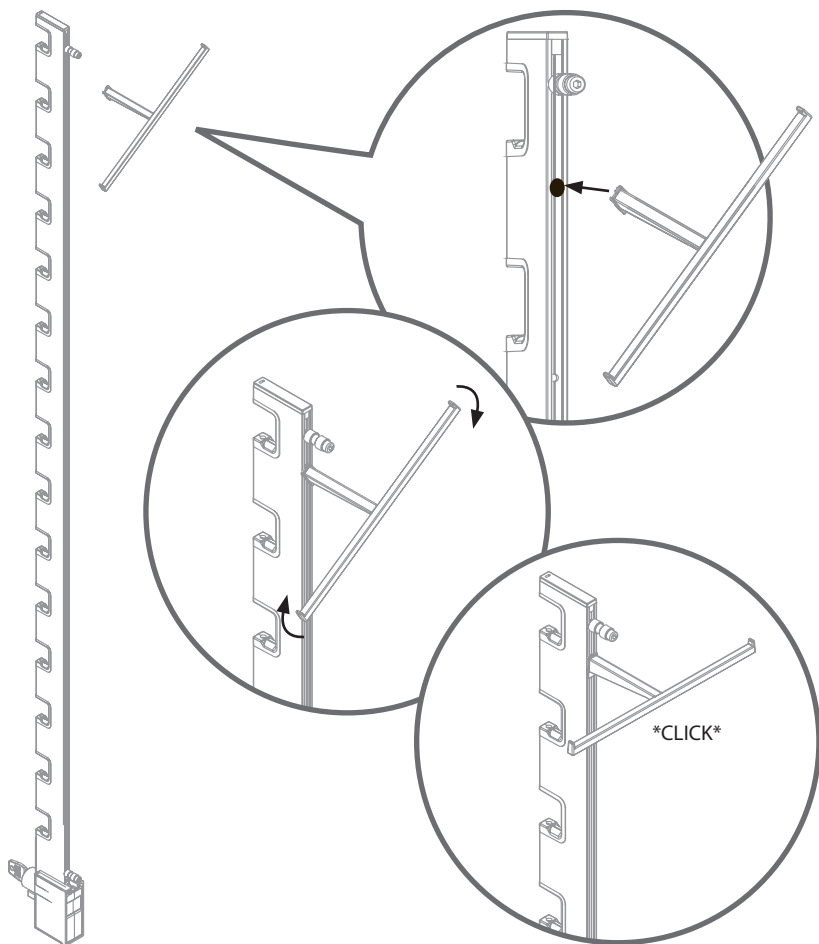
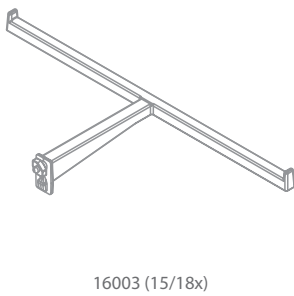
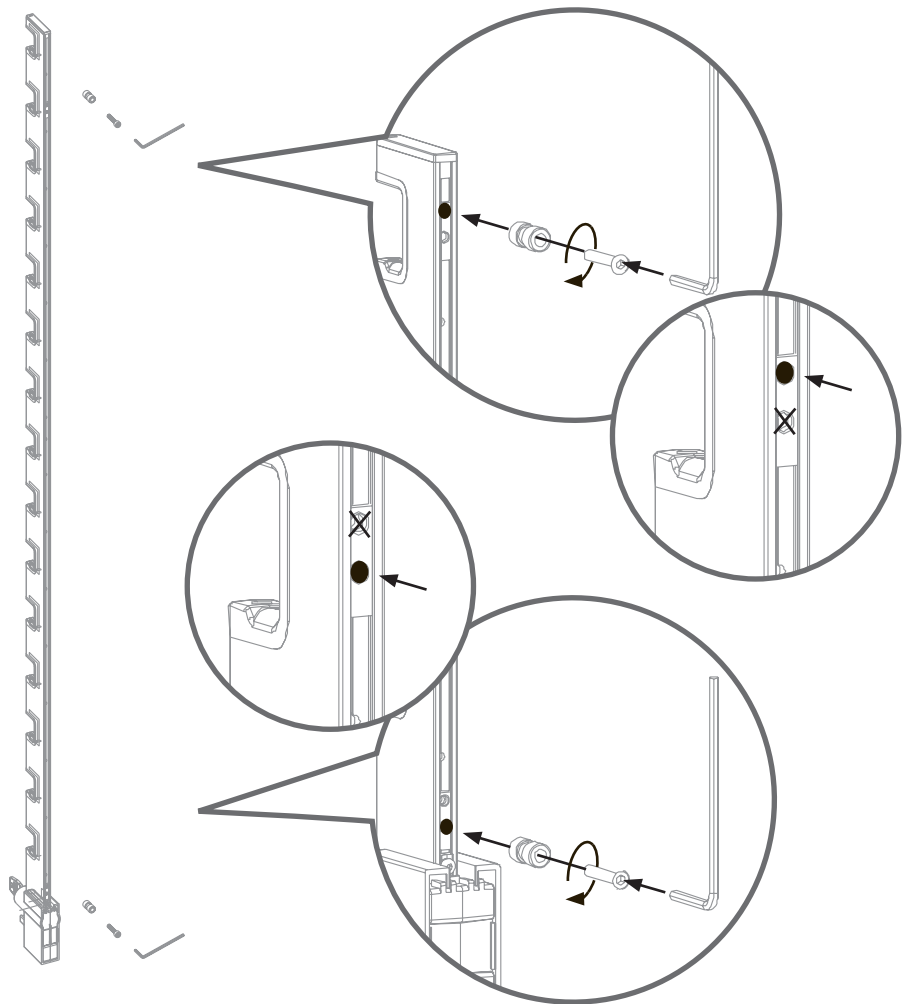



16905 (2x)
M4x4



92041 (1x)
#2

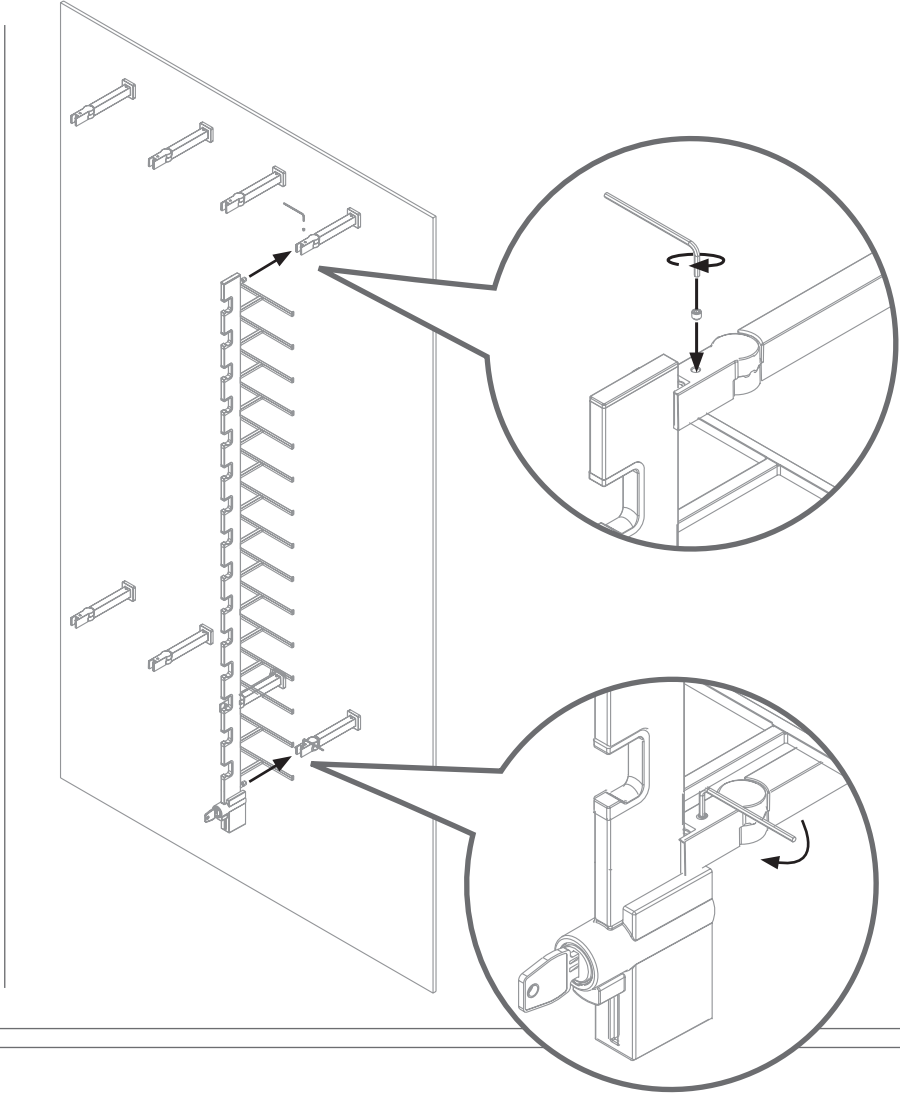

APPLICATION	ANWENDUNG	APLICACIÓN	APPLICATION	GEbruik

Head office - The Netherlands

Top Vision Group B.V.
Waarderweg 58
2031 BP Haarlem
The Netherlands

Tel: +31 23 517 66 77
Fax: +31 23 531 02 41
info@topvisiongroup.com
www.topvisiongroup.com